



Park  
2.10

DEPARTMENT OF  
PARKS AND RECREATION

**CITY OF SACRAMENTO**  
CALIFORNIA

1231 I STREET, #400  
SACRAMENTO, CA  
95814-2997

ADMINISTRATION

(916) 264-5200  
FAX 264-7643

August 15, 2002

City Council  
Sacramento, California

Honorable Members in Session:

**SUBJECT: Del Paso Regional Park Master Plan Amendment to Include the Adjacent "Longview Oaks" Site Project: Amendment to the Del Paso Regional Park Master Plan to Include the Adjacent "Longview Oaks" Site, Ratification of the Mitigated Negative Declaration, and Adoption of the Mitigation Reporting Plan**

**LOCATION AND COUNCIL DISTRICT:** Longview Oaks adjacent to Del Paso Regional Park, Council District 2

**RECOMMENDATION:** This report recommends the City Council, by resolution: 1) amend the Del Paso Regional Park Master Plan to incorporate the "Longview Oaks" parcel which is City property and is adjacent to the existing park just north of Longview Drive (Assessor's Parcel Number 240-0330-004), 2) ratify the Mitigated Negative Declaration and 3) adopt the Mitigation Reporting Plan for the "Longview Oaks" site.

**CONTACT PERSON:** Lori Harder, Administrative Officer, 264-5172

**FOR COUNCIL MEETING OF:** September 10, 2002

**SUMMARY:**

Longview Oaks is a 7.45 acre site immediately north of the existing Del Paso Regional Park. The Longview Oaks parcel is north of Longview Drive and south of Interstate-80 within the City of Sacramento. The site is owned by the City of Sacramento, is undeveloped and contains an oak savanna. Staff recommends this site be incorporated into the boundary of Del Paso Regional Park, that the Mitigated Negative Declaration for the site be ratified, and the Mitigation Reporting Plan be adopted.



Optimize the Experience of Living!

1

**COMMITTEE/COMMISSION ACTION:**

On January 3, 2002, the Parks and Recreation Citizen's Advisory Committee approved the addition of the "Longview Oaks" parcel to the Del Paso Regional Park Master Plan.

**BACKGROUND INFORMATION:**

Longview Oaks is a 7.45 acre parcel north of Longview Drive and south of Interstate-80 (Assessor's Parcel Number 240-0330-004). See site map attached as Exhibit A. The parcel features a tributary to the Arcade Creek which flows through seasonal wetlands and an oak savanna. The City's General Plan land use designation is for Parks and Recreation - Open Space. The project site is currently vacant and undeveloped and will be restored and enhanced through a State Department of Water Resources grant. The restoration and enhancement of the site includes restoring a vernal pool area, constructing a new detention wetland, removing existing asphalt road spurs, planting oak seedlings, removing non-native grasses, installing a pedestrian loop path, establishing a native grassland area, and repairing an on-site culvert. Longview Oaks is a beautiful open space area that staff recommends be incorporated into Del Paso Regional Park.

A revised Del Paso Regional Park Master Plan was adopted by the City Council on January 22, 1985 and included the Sacramento Softball Complex, which is a four-field lighted softball complex, a 500-space parking lot, a warm-up area and a picnic area. The Master Plan also preserved the natural habitat west of Watt Avenue. The 1985 revised Master Plan did not include the "Longview Oaks" site as part of the park.

The addition of the "Longview Oaks" site into the Del Paso Regional Park Master Plan will not change the City of Sacramento's General Plan. Staff recommends that the Del Paso Regional Park Revised Master Plan be amended to include the "Longview Oaks" site and that the Mitigated Negative Declaration for the site be ratified and the Mitigation Reporting Plan be adopted.

**FINANCIAL CONSIDERATIONS:**

None with this report.

**ENVIRONMENTAL CONSIDERATIONS:**

The City of Sacramento, Environmental Planning Services, has determined that the project, as proposed, will not have a significant impact to the environment; therefore, a Mitigated Negative Declaration has been prepared. In compliance with Section 15070(B)1 of the California Environmental Quality Act (CEQA) Guidelines, the City has incorporated mandatory mitigation

measures into the project plans to avoid identified impacts or to mitigate such impacts to a point where clearly no significant impacts will occur. These mitigation measures are included in Attachment A (Mitigation Reporting Plan) and address impacts to Geology, Water, Air Quality, Biological Resources, Hazards, Noise, and Cultural Resources.

The Mitigated Negative Declaration was distributed through the State Clearinghouse (SCH #2002052092) and available for public review during the period of May 21, 2002 through June 19, 2002. One public comment letter was received during the public review period. The comments received relating to the Mitigated Negative Declaration were not considered to substantially revise the document per CEQA Guideline Section 15073.5. Staff recommends that the City Council ratify the Mitigated Negative Declaration and adopt the Mitigation Reporting Plan for the project.

**POLICY CONSIDERATIONS:**

This project is consistent with the City's approved strategic Plan, *City Strategies*, enhancing the quality of life for present and future generations and preserving and enhancing park and recreation amenities.

**ESBD CONSIDERATIONS:**

No ESBD considerations are applicable at this time as no goods or services are being procured as a result of the approval of this recommendation.

Respectfully Submitted,



ROBERT G. OVERSTREET  
Director of Parks and Recreation

Recommendation Approved:



ROBERT P. THOMAS  
City Manager

**Attachments:**

Exhibit A: Del Paso Regional Park Master Plan Amendment to Incorporate Longview Oaks  
Mitigation Reporting Plan

Exhibit B: Site Map of the Longview Oaks Parcel.

Exhibit C: Del Paso Regional Park Master Plan

**RESOLUTION NO. 2002-605**

ADOPTED BY THE SACRAMENTO CITY COUNCIL

ON DATE OF: SEP 10 2002

**DEL PASO REGIONAL PARK MASTER PLAN AMENDMENT TO INCLUDE THE ADJACENT "LONGVIEW OAKS" SITE PROJECT: AMENDMENT TO THE DEL PASO REGIONAL PARK MASTER PLAN TO INCLUDE THE ADJACENT "LONGVIEW OAKS" SITE, RATIFICATION OF THE MITIGATED NEGATIVE DECLARATION, AND ADOPTION OF THE MITIGATION REPORTING PLAN**

**BE IT RESOLVED BY THE COUNCIL OF THE CITY OF SACRAMENTO that:**

**WHEREAS**, the Environmental Coordinator has prepared a Initial Study and Mitigated Negative Declaration for the above identified project;

**WHEREAS**, this Initial Study and Mitigated Negative Declaration have been circulated for public review and comment pursuant to the California Environmental Quality Act (CEQA);

**WHEREAS**, on the basis of the whole record before it, the City has determined that there is no substantial evidence that the project, with mitigation measures as identified in the Initial Study, will have a significant effect on the environment;

**WHEREAS**, this Mitigated Negative Declaration reflects the lead agency's independent judgment and analysis;

**WHEREAS**, in accordance with Section 21081.6 of the California Public Resources Code, the City of Sacramento requires that a Mitigation Reporting Plan be developed for implementing mitigation measures as identified in the Initial Study for the project; and

**WHEREAS**, the Environmental Coordinator has prepared a Mitigation Reporting Plan for ensuring compliance and implementation of the mitigation measures as prescribed in the Initial Study for the above identified project;

---

**FOR CITY CLERK USE ONLY**

RESOLUTION NO.: 2002-605

DATE ADOPTED: SEP 10 2002

**NOW, THEREFORE, BE IT RESOLVED BY THE COUNCIL OF THE CITY OF SACRAMENTO THAT:**

**The City Council hereby:**

1. Amends the Del Paso Regional Park Master Plan to incorporate the "Longview Oaks" parcel which is adjacent to the existing park along Longview Drive (Assessor's Parcel Number 240-0330-004) and ratifies the Negative Declaration for the "Longview Oaks" site.
2. The Mitigated Negative Declaration be Ratified and the Mitigation Reporting Plan for the Project be approved and adopted as shown in the attached Mitigation Reporting Plan.

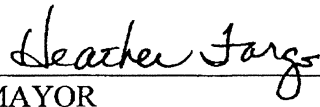
  
MAYOR

ATTEST:

  
CITY CLERK

---

**FOR CITY CLERK USE ONLY**

RESOLUTION NO.: 2002-605

DATE ADOPTED: SEP 10 2002

**Del Paso Regional Park Master Plan Amendment to Incorporate the "Longview Oaks" Site Mitigation Reporting Plan (CIP#LL06, Job#7208)**

In January 1989, Assembly Bill 3180 went into effect requiring the City to monitor all mitigation measures included in this Negative Declaration. For this project, mitigation reporting will be performed by the City of Sacramento Department of Parks and Recreation in accordance with the monitoring and reporting program developed by the City to implement AB 3180.

This Mitigation Reporting Plan is being prepared by the Planning and Building, Environmental Planning Services, 1231 I Street, Suite 300, Sacramento, CA 95814, (916) 264-5375, pursuant to the California Environmental Quality Guidelines, Section 21081.

The Department of Parks and Recreation will submit its completed Reporting Plan to the Environmental Planning Services for inclusion in the annual report to the City Council.

**Project Number:** CIP #LL06, Job #7208

**Project Name:** Del Paso Regional Park Master Plan Amendment to Incorporate the "Longview Oaks" Site

**Project Location:** The project is located north of Longview Drive and south of Interstate-80. This project includes the addition of 7.45 acres of Assessor's Parcel Number (APN) 240-0330-004 to the existing Del Paso Regional Park, located south and adjacent to Longview Drive.

**Project Description:** The City of Sacramento, Parks and Recreation Department, is proposing to amend the Del Paso Regional Park Master Plan to add 7.45 acres of APN 240-0330-004, located north of Longview Drive and directly south of Interstate-80, to Del Paso Regional Park. This project also involves enhancing and restoring the site by implementing a vernal pool restoration area, constructing a new detention basin, removing existing asphalt road spurs, planting oak seedlings, removing non-native grasses, establishing a native grassland area, and repairing an on-site historic culvert.

**MITIGATION REPORTING PROGRAM CHECKLIST FOR THE DEL PASO REGIONAL PARK MASTER PLAN AMENDMENT  
TO INCORPORATE THE "LONGVIEW OAKS" SITE NEGATIVE DECLARATION (CIP# LL06, Job #7208)**

| Mitigation Measure                                                                                                                                                                                                                                                                                                                                                                              | Reporting Milestone                   | Reporting/Responsible Party         | VERIFICATION OF COMPLIANCE |      |         |
|-------------------------------------------------------------------------------------------------------------------------------------------------------------------------------------------------------------------------------------------------------------------------------------------------------------------------------------------------------------------------------------------------|---------------------------------------|-------------------------------------|----------------------------|------|---------|
|                                                                                                                                                                                                                                                                                                                                                                                                 |                                       |                                     | Initials                   | Date | Remarks |
| <b>SEISMICITY, SOILS AND GEOLOGY</b>                                                                                                                                                                                                                                                                                                                                                            |                                       |                                     |                            |      |         |
| 1. In-channel construction activities shall be limited to the summer low-precipitation period (April 1 to October 15). By keeping construction within the low-precipitation months, the risk of bank erosion will be decreased. Streambanks and adjacent areas that are disturbed by construction activities will be stabilized to avoid increased erosion during subsequent storms and runoff. | Prior, during, and after construction | Dept. of Parks & Rec and Contractor |                            |      |         |

(7)

| Mitigation Measure                                                                                                                                                                                                                                                   | Reporting Milestone           | Reporting/Responsible Party         | VERIFICATION OF COMPLIANCE |      |         |
|----------------------------------------------------------------------------------------------------------------------------------------------------------------------------------------------------------------------------------------------------------------------|-------------------------------|-------------------------------------|----------------------------|------|---------|
|                                                                                                                                                                                                                                                                      |                               |                                     | Initials                   | Date | Remarks |
| <b>WATER</b>                                                                                                                                                                                                                                                         |                               |                                     |                            |      |         |
| 1. A Section 404 Permit from the U.S. Army Corps of Engineers, a Section 401 Water Quality Certification from the Regional Water Quality Control Board, and a 1601 Streambed Alteration Agreement from the California Department of Fish and Game shall be obtained. | Prior to construction         | Dept. of Parks & Rec                |                            |      |         |
| 2. All conditions within the permits shall be followed and implemented.                                                                                                                                                                                              | During and after construction | Dept. of Parks & Rec and Contractor |                            |      |         |





| Mitigation Measure                                                                                                                                                                                                           | Reporting Milestone | Reporting/Responsible Party          | VERIFICATION OF COMPLIANCE |      |         |
|------------------------------------------------------------------------------------------------------------------------------------------------------------------------------------------------------------------------------|---------------------|--------------------------------------|----------------------------|------|---------|
|                                                                                                                                                                                                                              |                     |                                      | Initials                   | Date | Remarks |
| <b>AIR QUALITY</b>                                                                                                                                                                                                           |                     |                                      |                            |      |         |
| 1. Water exposed soil with adequate frequency to keep soil moist at all times.                                                                                                                                               | During construction | Dept. of Parks & Rec. and Contractor |                            |      |         |
| 2. Cover load of haul/dump trucks securely.                                                                                                                                                                                  | During construction | Dept. of Parks & Rec. and Contractor |                            |      |         |
| 3. Construction activities shall comply with Sacramento Metropolitan Air Quality Management District rule 405 on dust and condensed fumes, so that emissions do not exceed hourly levels as regulated per processing weight. | During construction | Dept. of Parks & Rec. and Contractor |                            |      |         |
| 4. The Contractor shall follow the Sacramento Metropolitan Air Quality Management District's Fugitive Dust 403 Rule in order to ensure that dust is reduced to a level of less-than-significant.                             | During construction | Dept. of Parks & Rec. and Contractor |                            |      |         |
| 5. Construction equipment shall be maintained and tuned at the interval recommended by the manufacturers to minimize exhaust emissions and odors and increase fuel efficiency.                                               | During construction | Dept. of Parks & Rec. and Contractor |                            |      |         |
| 6. Equipment idling shall be kept to a minimum when equipment is not in use. No piece of equipment shall be left to idle in one place for more than 30 minutes.                                                              | During construction | Dept. of Parks & Rec. and Contractor |                            |      |         |
| 7. Enclose, cover or water twice daily all soil piles.                                                                                                                                                                       | During construction | Dept. of Parks & Rec. and Contractor |                            |      |         |
| 8. Water all haul roads twice daily.                                                                                                                                                                                         | During construction | Dept. of Parks & Rec. and Contractor |                            |      |         |



| Mitigation Measure                                                                                                                                                                                                                                                                                                                                                                                                                                                                                                                                                                                                                                                                                                                                       | Reporting Milestone           | Reporting/Responsible Party          | VERIFICATION OF COMPLIANCE |      |         |
|----------------------------------------------------------------------------------------------------------------------------------------------------------------------------------------------------------------------------------------------------------------------------------------------------------------------------------------------------------------------------------------------------------------------------------------------------------------------------------------------------------------------------------------------------------------------------------------------------------------------------------------------------------------------------------------------------------------------------------------------------------|-------------------------------|--------------------------------------|----------------------------|------|---------|
|                                                                                                                                                                                                                                                                                                                                                                                                                                                                                                                                                                                                                                                                                                                                                          |                               |                                      | Initials                   | Date | Remarks |
| AIR QUALITY (continued from previous page)                                                                                                                                                                                                                                                                                                                                                                                                                                                                                                                                                                                                                                                                                                               |                               |                                      |                            |      |         |
| 9. The prime contractor shall provide a plan for approval by the City of Sacramento demonstrating that replacement heavy-duty (>50 horsepower) off-road vehicles to be used in the mining of the project and operated by either the prime contractor or any subcontractor, will achieve a fleet-averaged 20 percent NOx reduction and 45 percent particulate reduction compared to the most recent CARB fleet average.                                                                                                                                                                                                                                                                                                                                   | Prior to construction         | Dept. of Parks & Rec. and Contractor |                            |      |         |
| 10. The prime contractor shall submit to the City of Sacramento a comprehensive inventory of all off-road equipment used in the mining operation, equal to or greater than 50 horsepower, that will be used an aggregate of 40 or more hours during the construction period. The inventory shall be updated and submitted monthly throughout the duration of the construction period, except that an inventory shall not be required for any 30-day period in which no activity occurs. At least 48 hours prior to the use of subject heavy-duty off-road equipment, the prime contractor shall provide SMAQMD with the anticipated mining activity timeline including start date, and name and phone number of the project manager and on-site foreman. | Prior and during construction | Dept. of Parks & Rec. and Contractor |                            |      |         |
| 11. Enclose, cover or water twice daily all soil piles.                                                                                                                                                                                                                                                                                                                                                                                                                                                                                                                                                                                                                                                                                                  | During construction           | Dept. of Parks & Rec. and Contractor |                            |      |         |
| 12. Water all haul roads twice daily.                                                                                                                                                                                                                                                                                                                                                                                                                                                                                                                                                                                                                                                                                                                    | During construction           | Dept. of Parks & Rec. and Contractor |                            |      |         |

5

| Mitigation Measure                                                                                                                                                                                                                                                                                                                                                                                                                                                                                                                                                                                                                                                                                                                                                                                                                                                                                                                                                                                                                                                                                                                                                       | Reporting Milestone                    | Reporting/Responsible Party         | VERIFICATION OF COMPLIANCE |      |         |
|--------------------------------------------------------------------------------------------------------------------------------------------------------------------------------------------------------------------------------------------------------------------------------------------------------------------------------------------------------------------------------------------------------------------------------------------------------------------------------------------------------------------------------------------------------------------------------------------------------------------------------------------------------------------------------------------------------------------------------------------------------------------------------------------------------------------------------------------------------------------------------------------------------------------------------------------------------------------------------------------------------------------------------------------------------------------------------------------------------------------------------------------------------------------------|----------------------------------------|-------------------------------------|----------------------------|------|---------|
|                                                                                                                                                                                                                                                                                                                                                                                                                                                                                                                                                                                                                                                                                                                                                                                                                                                                                                                                                                                                                                                                                                                                                                          |                                        |                                     | Initials                   | Date | Remarks |
| <b>BIOLOGICAL RESOURCES</b>                                                                                                                                                                                                                                                                                                                                                                                                                                                                                                                                                                                                                                                                                                                                                                                                                                                                                                                                                                                                                                                                                                                                              |                                        |                                     |                            |      |         |
| <u>Special-status species</u>                                                                                                                                                                                                                                                                                                                                                                                                                                                                                                                                                                                                                                                                                                                                                                                                                                                                                                                                                                                                                                                                                                                                            |                                        |                                     |                            |      |         |
| <p>1. Noxious weeds degrade habitat quality by removing habitat for native plant and wildlife species. To avoid the introduction or spread of noxious weeds into previously uninfested areas, the following mitigation measures shall be implemented to ensure potential impacts are reduced to a less-than-significant level:</p> <ul style="list-style-type: none"> <li>• Educate construction supervisors and managers on weed identification and the importance of controlling and preventing the spread of noxious weed infestations.</li> <li>• Clean construction equipment immediately prior to transporting into Sacramento County.</li> <li>• Seed all disturbed areas with certified weed-free native mixes. Mulch with certified weed-free mulch. Rice straw may be used to mulch upland areas.</li> <li>• Conduct a follow-up inventory of the construction area to verify that construction activities have not resulted in the introduction of new noxious weed infestations. If new noxious weed infestations are located during the follow-up inventory, the appropriate species-specific treatment methods for removal will be implemented.</li> </ul> | Before, during, and after construction | Dept. of Parks & Rec and Contractor |                            |      |         |



| Mitigation Measure                                                                                                                                                                                                                                                                                                                                                                                                                                                                                                                                                                                                                                                                                                                                                                                                                                                                                                                                                                                                                                                                                                                                                                                                                                                                                                                                                                                                                                                                     | Reporting Milestone           | Reporting/Responsible Party         | VERIFICATION OF COMPLIANCE |      |         |
|----------------------------------------------------------------------------------------------------------------------------------------------------------------------------------------------------------------------------------------------------------------------------------------------------------------------------------------------------------------------------------------------------------------------------------------------------------------------------------------------------------------------------------------------------------------------------------------------------------------------------------------------------------------------------------------------------------------------------------------------------------------------------------------------------------------------------------------------------------------------------------------------------------------------------------------------------------------------------------------------------------------------------------------------------------------------------------------------------------------------------------------------------------------------------------------------------------------------------------------------------------------------------------------------------------------------------------------------------------------------------------------------------------------------------------------------------------------------------------------|-------------------------------|-------------------------------------|----------------------------|------|---------|
|                                                                                                                                                                                                                                                                                                                                                                                                                                                                                                                                                                                                                                                                                                                                                                                                                                                                                                                                                                                                                                                                                                                                                                                                                                                                                                                                                                                                                                                                                        |                               |                                     | Initials                   | Date | Remarks |
| <b>BIOLOGICAL RESOURCES</b> (continued from previous page)                                                                                                                                                                                                                                                                                                                                                                                                                                                                                                                                                                                                                                                                                                                                                                                                                                                                                                                                                                                                                                                                                                                                                                                                                                                                                                                                                                                                                             |                               |                                     |                            |      |         |
| <p>2. The project site provides potential habitat for raptors. If avoidance is the preferred method of dealing with potential impacts to raptors, then construction shall begin outside the nesting season of March 1-July 31. No further surveys or further mitigation would be required if construction were to occur outside of the nesting season.</p> <p>If construction and restoration activities are scheduled to occur during the nesting season for raptors (March 1-July 31), then a qualified biologist will conduct a preconstruction nesting season survey for these species. If the biologist determines that special-status raptors are nesting within the project area, then the project proponent should establish a no-disturbance buffer around the active nest during the breeding season. The size of the individual buffer will depend on the species and an evaluation of the site by a qualified raptor biologist. Factors that affect the size of the no-disturbance buffer zone include the presence of topographical features that obstruct the line of site from the construction activities to the nest, as well as existing peak noise and other nondestructive disturbance levels at the start of the nesting season. To minimize the possibility of nest abandonment, no construction activities would occur within the specified buffer zone during the breeding season (March 1-July 31) or until it is determined that the young have fledged.</p> | Prior and during construction | Dept. of Parks & Rec and Contractor |                            |      |         |

| Mitigation Measure                                                                                                                                                                                                                                                                                                                                                                                                                                                                                                                                                                                                                                                                                                                                                                                                                                                 | Reporting Milestone                   | Reporting/Responsible Party         | VERIFICATION OF COMPLIANCE |      |         |
|--------------------------------------------------------------------------------------------------------------------------------------------------------------------------------------------------------------------------------------------------------------------------------------------------------------------------------------------------------------------------------------------------------------------------------------------------------------------------------------------------------------------------------------------------------------------------------------------------------------------------------------------------------------------------------------------------------------------------------------------------------------------------------------------------------------------------------------------------------------------|---------------------------------------|-------------------------------------|----------------------------|------|---------|
|                                                                                                                                                                                                                                                                                                                                                                                                                                                                                                                                                                                                                                                                                                                                                                                                                                                                    |                                       |                                     | Initials                   | Date | Remarks |
| BIOLOGICAL RESOURCES (continued from previous page)                                                                                                                                                                                                                                                                                                                                                                                                                                                                                                                                                                                                                                                                                                                                                                                                                |                                       |                                     |                            |      |         |
| 3. To reduce the potential for short-term water quality impacts associated with construction of the detention basin, a Department of Fish and Game 1601 Streambed Alteration Agreement, a Section 404 U.S. Army Corps of Engineers Permit, and a Section 401 Water Quality Certification shall be obtained. Requirements in the permits shall be followed and implemented. The requirements of the permits will limit disturbance or removal of vegetation and include measures to minimize siltation of downstream habitats. No construction shall occur in the ephemeral drainages until the permits are obtained.                                                                                                                                                                                                                                               | Prior, during, and after construction | Dept. of Parks & Rec and Contractor |                            |      |         |
| 4. The Migratory Bird Treaty Act protects migratory birds, including nests and their contents, from pursuing, hunting, taking, capturing, or killing. Woody vegetation that must be removed as part of the project will be removed during the nonbreeding season for migratory birds (August 15–March 15). Peak noise and other nondestructive disturbance levels will be determined at the start of the nesting season (March 15–May 1) in order to create the basis for nesting birds to establish their thresholds of tolerance to these disturbances. Birds that choose to nest under such conditions will not be adversely affected by these breeding season disturbances; therefore, no other mitigation is required. Known or potential unoccupied nesting sites such as trees with cavities, snags, and brush will be protected to the extent practicable. | Prior and during construction         | Dept. of Parks & Rec and Contractor |                            |      |         |

13

| Mitigation Measure                                                                                                                                                                                                                                                                                                                                                                                                                                                             | Reporting Milestone            | Reporting/Responsible Party         | VERIFICATION OF COMPLIANCE |      |         |
|--------------------------------------------------------------------------------------------------------------------------------------------------------------------------------------------------------------------------------------------------------------------------------------------------------------------------------------------------------------------------------------------------------------------------------------------------------------------------------|--------------------------------|-------------------------------------|----------------------------|------|---------|
|                                                                                                                                                                                                                                                                                                                                                                                                                                                                                |                                |                                     | Initials                   | Date | Remarks |
| <b>BIOLOGICAL RESOURCES</b> (continued from previous page)                                                                                                                                                                                                                                                                                                                                                                                                                     |                                |                                     |                            |      |         |
| <u>Trees</u>                                                                                                                                                                                                                                                                                                                                                                                                                                                                   |                                |                                     |                            |      |         |
| 1. Construction that requires any cutting of roots over two inches in diameter needs to be approved by the City of Sacramento, Tree Services before proceeding. These roots need to be exposed by hand digging before inspections are requested.                                                                                                                                                                                                                               | Before and during construction | Dept. of Parks & Rec and Contractor |                            |      |         |
| 2. The contractor shall hire an International Society of Arboriculture (ISA) certified arborist to do any required pruning for equipment clearance. The contractor shall contact the City Arborist (Dan Pskowski, 768-8604) for a root inspection(s) for trenching activities within the dripline(s) of the trees.                                                                                                                                                             | Before construction            | Dept. of Parks & Rec and Contractor |                            |      |         |
| 3. If during excavation for the project, tree roots greater than two inches in diameter are encountered, work shall stop immediately until the project arborist can perform an on-site inspection. All roots shall be cut clean and the tree affected may require supplemental irrigation/fertilization and pruning as a result of the root cutting. The project sponsor will be responsible for any costs incurred.                                                           | During construction            | Dept. of Parks & Rec and Contractor |                            |      |         |
| 4. The contractor shall be held liable for any damage to existing trees, i.e. trunk wounds, broken limbs, pouring of any deleterious materials, or concrete washout under the drip line of the trees. Damages will be assessed using the "Guide to Plant Appraisal" ninth edition, published by the International Society of Arboriculture (ISA). The contractor shall hire an ISA certified arborist to do the appraisal and submit a report for review by the City Arborist. | During and after construction  | Dept. of Utilities and Contractor   |                            |      |         |

(11)

| Mitigation Measure                                                                                                                                                                                                                                                                                                                                                                                                                                                                                                                                            | Reporting Milestone                   | Reporting/Responsible Party         | VERIFICATION OF COMPLIANCE |      |         |
|---------------------------------------------------------------------------------------------------------------------------------------------------------------------------------------------------------------------------------------------------------------------------------------------------------------------------------------------------------------------------------------------------------------------------------------------------------------------------------------------------------------------------------------------------------------|---------------------------------------|-------------------------------------|----------------------------|------|---------|
|                                                                                                                                                                                                                                                                                                                                                                                                                                                                                                                                                               |                                       |                                     | Initials                   | Date | Remarks |
| <b>BIOLOGICAL RESOURCES</b> (continued from previous page)                                                                                                                                                                                                                                                                                                                                                                                                                                                                                                    |                                       |                                     |                            |      |         |
| 5. Supplemental irrigation will be required for trees on and adjacent to the project site where the irrigation has been turned off or modified because of construction activities.                                                                                                                                                                                                                                                                                                                                                                            | During construction                   | Dept. of Parks & Rec and Contractor |                            |      |         |
| 6. The trees to be preserved and the protection methods noted above shall be identified on all construction plans for this project.                                                                                                                                                                                                                                                                                                                                                                                                                           | Before construction                   | Dept. of Parks & Rec and Contractor |                            |      |         |
| <b><u>Waters of the U.S. and Wetlands</u></b>                                                                                                                                                                                                                                                                                                                                                                                                                                                                                                                 |                                       |                                     |                            |      |         |
| 1. A Section 404 Clean Water Act (CWA) permit, a 1601 Streambed Alteration Agreement (SAA), and a Section 401 Clean Water Act Water Quality Certification shall be obtained prior to start of any work, including earthmoving, vegetation clearing, or grading activities.                                                                                                                                                                                                                                                                                    | Prior to construction                 | Dept. of Parks & Rec and Contractor |                            |      |         |
| 2. Conditions within the permits shall be followed and implemented.                                                                                                                                                                                                                                                                                                                                                                                                                                                                                           | Prior, during, and after construction | Dept. of Parks & Rec and Contractor |                            |      |         |
| 3. In-channel construction activities shall be limited to the summer low-precipitation period. To reduce the potential for construction-related impacts, construction of the detention basin shall be conducted during the summer low precipitation period (April 1 to October 15). By keeping construction within the low-precipitation months, the risk of bank erosion will be decreased. Streambanks and adjacent areas that are disturbed by construction activities shall be stabilized to avoid increased erosion during subsequent storms and runoff. | Prior, during, and after construction | Dept. of Parks & Rec and Contractor |                            |      |         |

| Mitigation Measure                                                                                                                                                                                                                                                                                                                                                                                                                                                                                                      | Reporting Milestone                    | Reporting/Responsible Party          | VERIFICATION OF COMPLETION |      | Remarks |
|-------------------------------------------------------------------------------------------------------------------------------------------------------------------------------------------------------------------------------------------------------------------------------------------------------------------------------------------------------------------------------------------------------------------------------------------------------------------------------------------------------------------------|----------------------------------------|--------------------------------------|----------------------------|------|---------|
|                                                                                                                                                                                                                                                                                                                                                                                                                                                                                                                         |                                        |                                      | Initials                   | Date |         |
| <b>HAZARDS</b>                                                                                                                                                                                                                                                                                                                                                                                                                                                                                                          |                                        |                                      |                            |      |         |
| 1. The asphalt that will be removed from the site shall be disposed of properly at a recycling facility.                                                                                                                                                                                                                                                                                                                                                                                                                | During and after construction          | Dept. of Parks & Rec and Contractor  |                            |      |         |
| 2. Construction contractor shall follow all necessary precautions, according to the California Health and Safety Codes, to prevent any spill of a toxic or hazardous substance, which includes preparation of a spill prevention plan to maintain safety of the drainage waterways. The construction contractor shall ensure proper labeling, storage, handling, and use of hazardous materials in accordance with best management practices and Occupational Safety and Health Administration's HAZWOPER requirements. | Before, during, and after construction | Dept. of Parks & Rec. and Contractor |                            |      |         |
| 3. Strict on-site handling rules shall be implemented to minimize spills and keep potentially contaminated materials out of the drainage waterways.                                                                                                                                                                                                                                                                                                                                                                     | Before, during, and after construction | Dept. of Parks & Rec. and Contractor |                            |      |         |
| 4. Wastes and petroleum products used during construction shall be collected and removed from the project site in accordance with the Resource Conservation and Recovery Act regulations and Fed/OSHA standards.                                                                                                                                                                                                                                                                                                        | During and after construction          | Dept. of Parks & Rec. and Contractor |                            |      |         |
| 5. If contaminated soil and/or groundwater is encountered or if suspected contamination is encountered during project construction, work shall be halted in the area, and the type and extent of the contamination shall be identified. A qualified professional, in consultation with the appropriate federal, state, and/or local regulatory agencies shall then develop an appropriate method to remediate the contamination.                                                                                        | During construction                    | Dept. of Parks & Rec. and Contractor |                            |      |         |

(16)



| Mitigation Measure                                                                                                                                                                                                                      | Reporting Milestone | Reporting/Responsible Party          | VERIFICATION OF COMPLIANCE |      |         |
|-----------------------------------------------------------------------------------------------------------------------------------------------------------------------------------------------------------------------------------------|---------------------|--------------------------------------|----------------------------|------|---------|
|                                                                                                                                                                                                                                         |                     |                                      | Initials                   | Date | Remarks |
| HAZARDS (continued from previous page)                                                                                                                                                                                                  |                     |                                      |                            |      |         |
| 6. The construction contractor shall ensure that employees are properly trained in the use of handling of these materials and that each material is accompanied by a material safety data sheet.                                        | Before construction | Dept. of Parks & Rec. and Contractor |                            |      |         |
| 7. All reserve fuel supplies and hazardous materials shall be stored on pallets within fenced and secured construction areas and protected from exposure to weather. Incompatible materials shall be stored separately, as appropriate. | During construction | Dept. of Parks & Rec. and Contractor |                            |      |         |
| 8. Equipment refueling and maintenance shall take place only within staging areas.                                                                                                                                                      | During construction | Dept. of Parks & Rec. and Contractor |                            |      |         |



| Mitigation Measure                                                                                             | Reporting Milestone           | Reporting/Responsible Party          | VERIFICATION OF COMPLIANCE |      |         |
|----------------------------------------------------------------------------------------------------------------|-------------------------------|--------------------------------------|----------------------------|------|---------|
|                                                                                                                |                               |                                      | Initials                   | Date | Remarks |
| NOISE                                                                                                          |                               |                                      |                            |      |         |
| 1. Equipment shall have sound-control devices no less effective than those provided on the original equipment. | Prior and during construction | Dept. of Parks & Rec. and Contractor |                            |      |         |
| 2. Equipment shall have muffled exhausts.                                                                      | Prior and during construction | Dept. of Parks & Rec. and Contractor |                            |      |         |



| Mitigation Measure                                                                                                                                                                                                                                                                                                                                                                                                                                                                   | Reporting Milestone | Reporting/Responsible Party         | VERIFICATION OF COMPLIANCE |      |         |
|--------------------------------------------------------------------------------------------------------------------------------------------------------------------------------------------------------------------------------------------------------------------------------------------------------------------------------------------------------------------------------------------------------------------------------------------------------------------------------------|---------------------|-------------------------------------|----------------------------|------|---------|
|                                                                                                                                                                                                                                                                                                                                                                                                                                                                                      |                     |                                     | Initials                   | Date | Remarks |
| <b>CULTURAL RESOURCES</b>                                                                                                                                                                                                                                                                                                                                                                                                                                                            |                     |                                     |                            |      |         |
| 1. If subsurface archaeological or historical remains are discovered during construction, work in the area shall stop immediately and a qualified archaeologist and a representative of the Native American Heritage Commission shall be consulted to develop, if necessary, further mitigation measures to reduce any archaeological impact to a less-than-significant level before construction continues.                                                                         | During construction | Dept. of Parks & Rec and Contractor |                            |      |         |
| 2. If human burials are encountered, all work in the area shall stop immediately and the Sacramento County Coroner's office shall be notified immediately. If the remains are determined to be Native American in origin, both the Native American Heritage Commission and any identified descendants must be notified and recommendations for treatment solicited (CEQA Section 15064.5); Health and Safety Code Section 7050.5; Public Resources Code Section 5097.94 and 5097.98. | During construction | Dept. of Parks & Rec and Contractor |                            |      |         |

19



**City of Sacramento**  
**Department of Parks and Recreation**  
 Longview Oaks

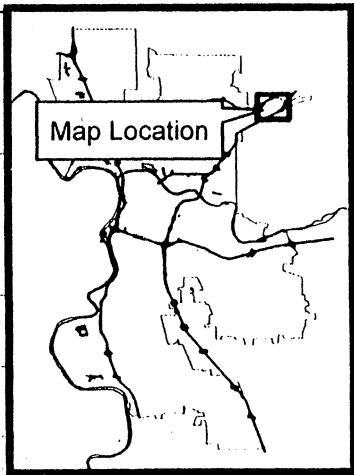

City Limits  
 Parcel 240-0330-004

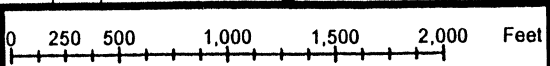
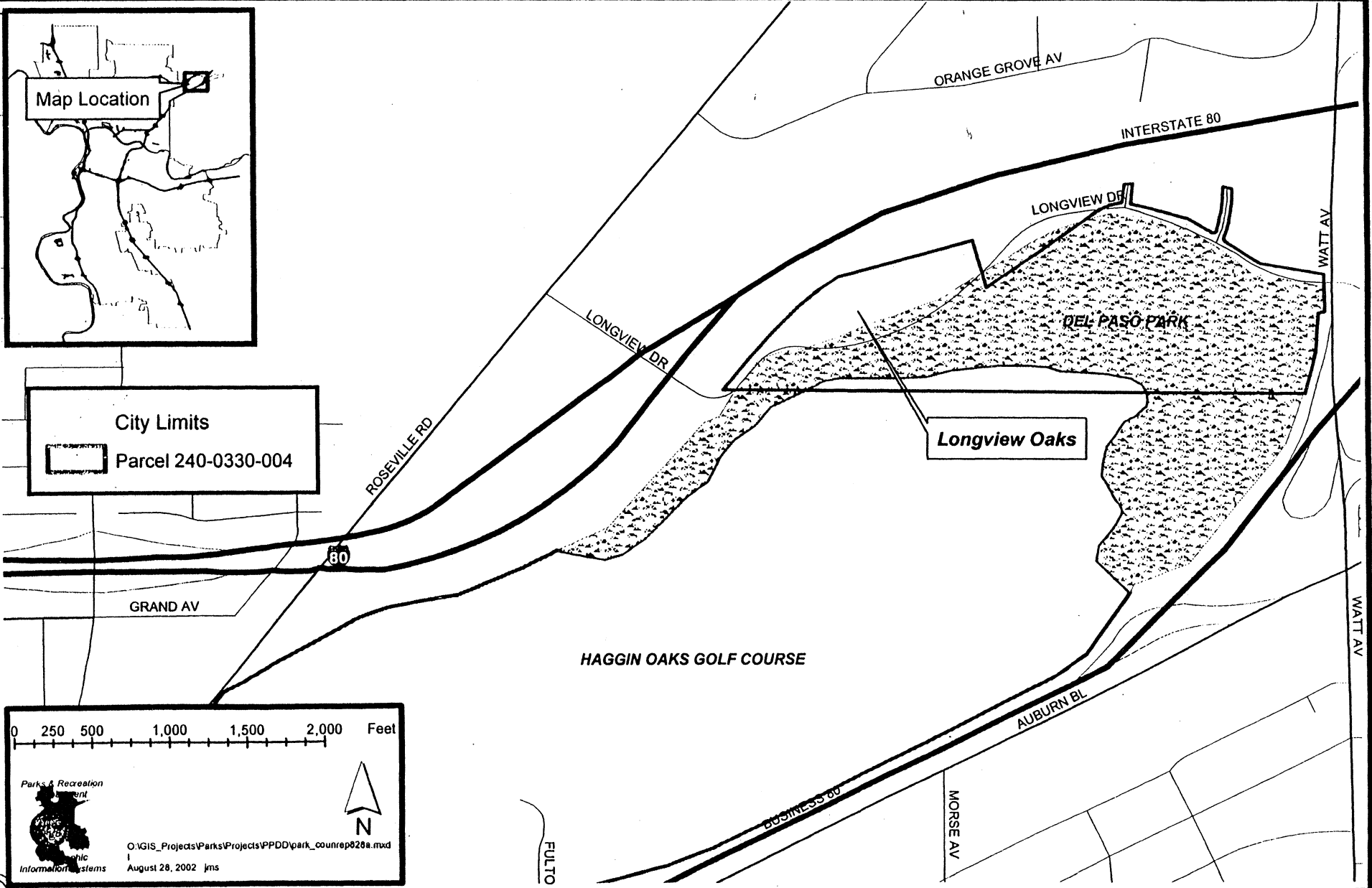

Parks & Recreation  
 Department  
 Public Information Systems

O:\GIS\_Projects\Parks\Projects\PPDD\park\_counrep020a.mxd  
 August 28, 2002 jms

Exhibit B

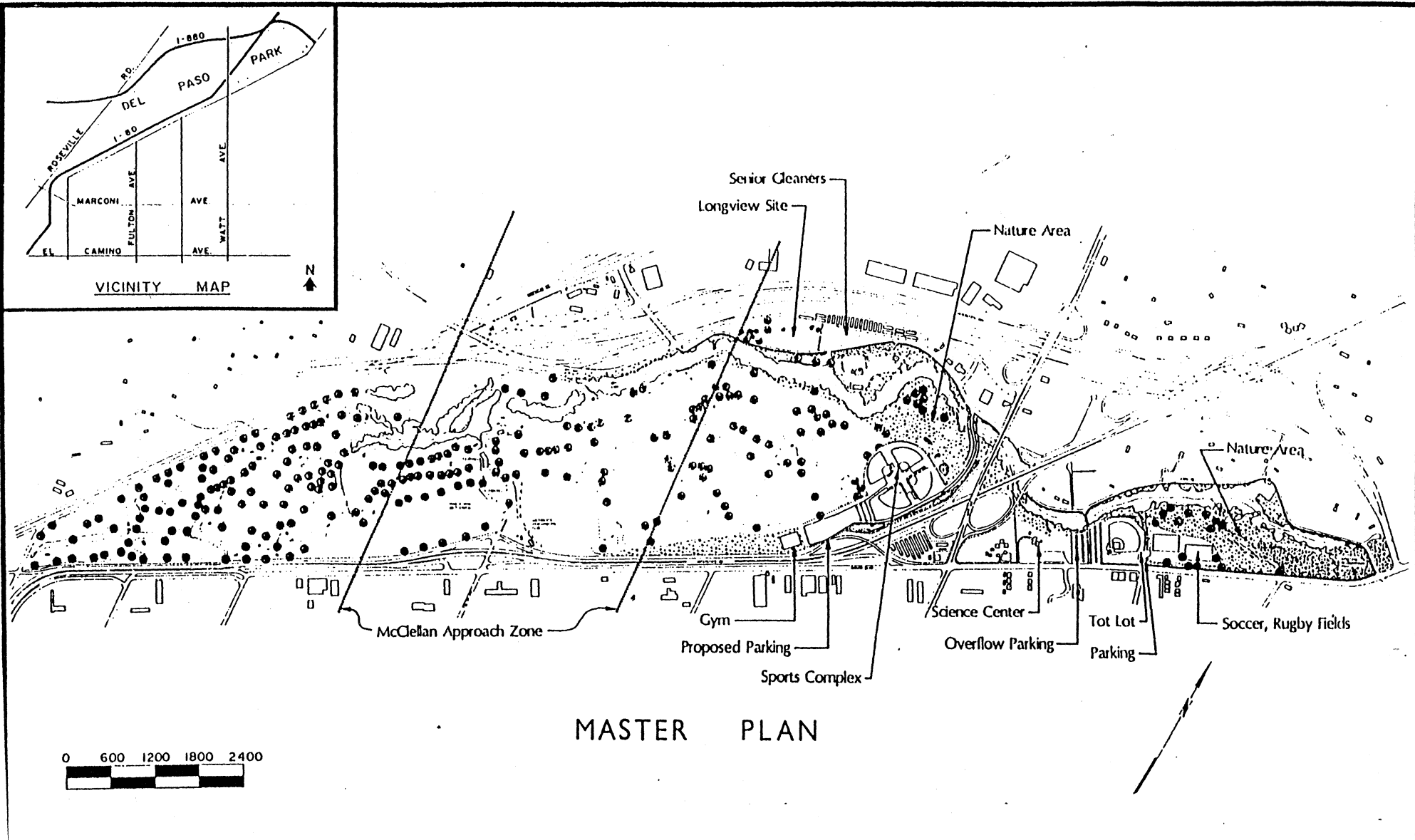

MASTER PLAN

| REVISIONS | NO. | DESCRIPTION | DATE | BY |
|-----------|-----|-------------|------|----|
|           |     |             |      |    |
|           |     |             |      |    |
|           |     |             |      |    |

|                     |            |
|---------------------|------------|
| DRAWN BY            | J. MAHANEY |
| DESIGNED BY         |            |
| LANDSCAPE ARCHITECT |            |
| DATE                | FEB 1965   |
| FIELD BOOK          |            |
| SCALE               |            |

CITY OF SACRAMENTO  
DEPARTMENT OF COMMUNITY SERVICES



DEL PASO PARK (679.03 AC.)

|        |  |
|--------|--|
| SHEET  |  |
| SHEETS |  |

21

EXHIBIT C



PLANNING & BUILDING  
DEPARTMENT

**CITY OF SACRAMENTO  
CALIFORNIA**

1231 I Street  
Room 300

Sacramento, CA  
95814-2998

Environmental Planning  
Services  
916-264-5375  
FAX 264-7185

**NEGATIVE DECLARATION**

The City of Sacramento, California, a municipal corporation, does hereby prepare, make, declare, and publish this Negative Declaration for the following described project:

**Del Paso Regional Park Master Plan Amendment to Incorporate the "Longview Oaks" Site (#LL06, 7208)** – The City of Sacramento, Parks and Recreation Department, is proposing to amend the Del Paso Regional Park Master Plan to officially add 7.45 acres of APN 240-0330-004, located north of Longview Drive and directly south of Interstate-80, to Del Paso Regional Park. This project also involves enhancing and restoring the site by implementing a vernal pool restoration area, constructing a new detention wetland, removing existing asphalt road spurs, planting oak seedlings, removing non-native grasses, installing a pedestrian loop path, establishing a native grassland area, and repairing an on-site culvert.

The City of Sacramento, Planning and Building Department, has reviewed the proposed project and has determined that the project, with mitigation measures, as identified in the attached Initial Study, will not have a significant effect on the environment. An Environmental Impact Report is not required pursuant to the Environmental Quality Act of 1970 (Sections 21000, et seq., Public Resources Code of the State of California).

This Negative Declaration has been prepared pursuant to Title 14, Section 15070 of the California Code of Regulations; the Sacramento Local Environmental Regulations (Resolution 91-892) adopted by the City of Sacramento; and the Sacramento City Code, Title 63.

A copy of this document and all supportive documentation may be reviewed or obtained at the City of Sacramento, Planning and Building Department, Planning Division, 1231 I Street, 3rd Floor, Sacramento, California 95814.

Environmental Planning Services Senior Planner  
City of Sacramento, California, a municipal corporation

By: *Colleen Laubinger*